

STUDENT GUIDE - 2022

Login to your account using the link in your welcome email.

If you have received a welcome email from DrillBit, it means that your instructor has been added you in the classroom to upload assignments.

If an instructor has added you in the classroom, but you have not received a welcome email from DrillBit, please check your spam or junk folder. Alternatively, contact your instructor to check that your account has been created successfully or not.

How to login into DrillBit Account?

1. Go to <https://www.drillbitplagiarism.com> or click on the link provided through the welcome email.

2. At the top right click on the "Get Started" button

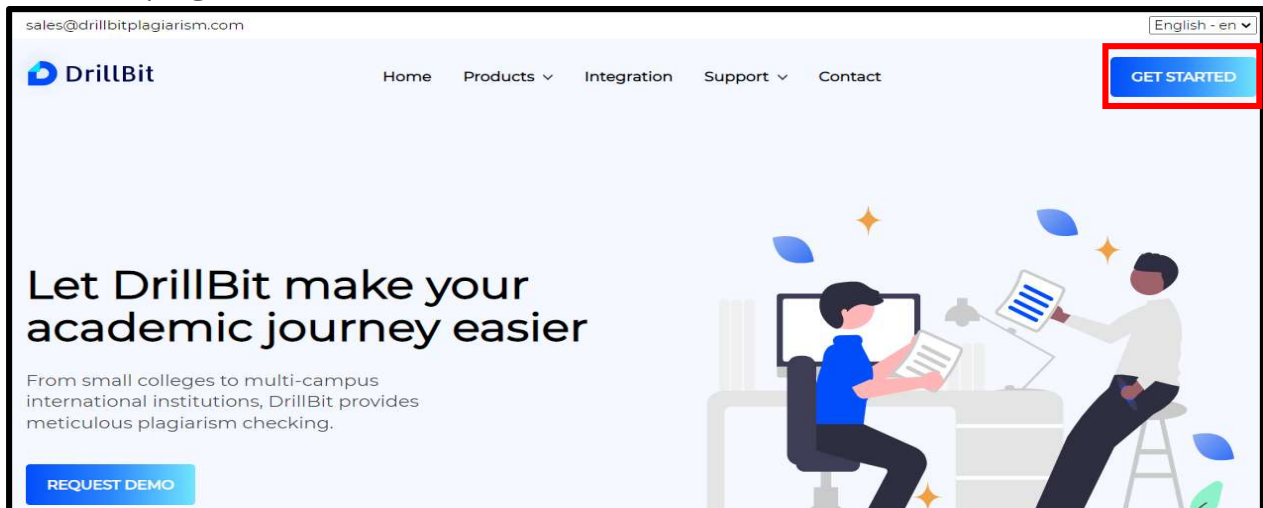

3. Enter the username and password and click on the Log In button

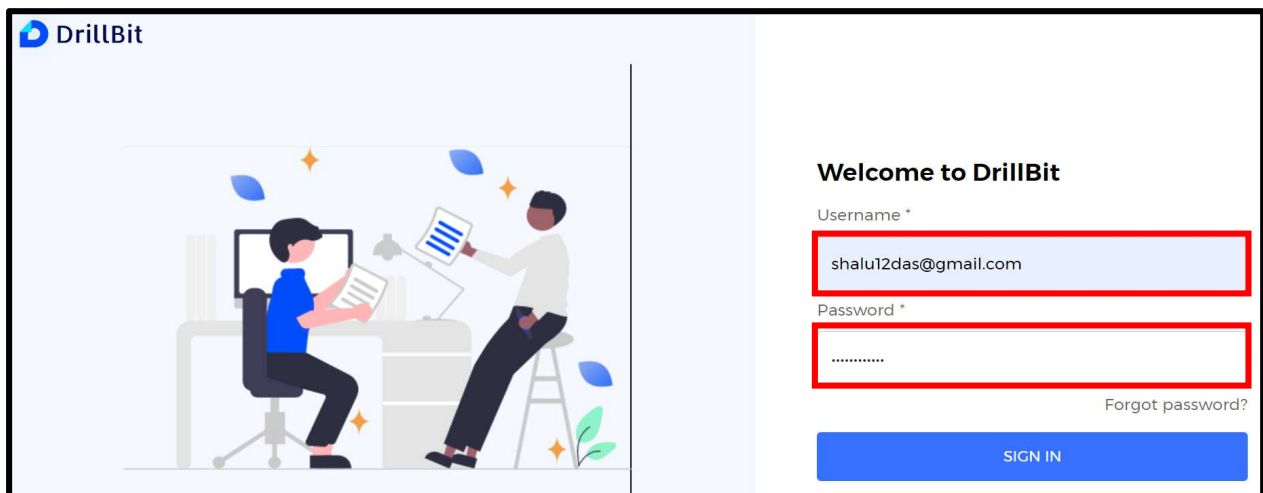

Student Dashboard

Classes: student enrollment in classes

Assignments: Total number of assignments created for student

Submissions: Total number of submissions by student

My recent submissions: latest submissions of student

Submissions overview: month wise submissions of student

Trend analysis: average similar work and own work of student total submissions

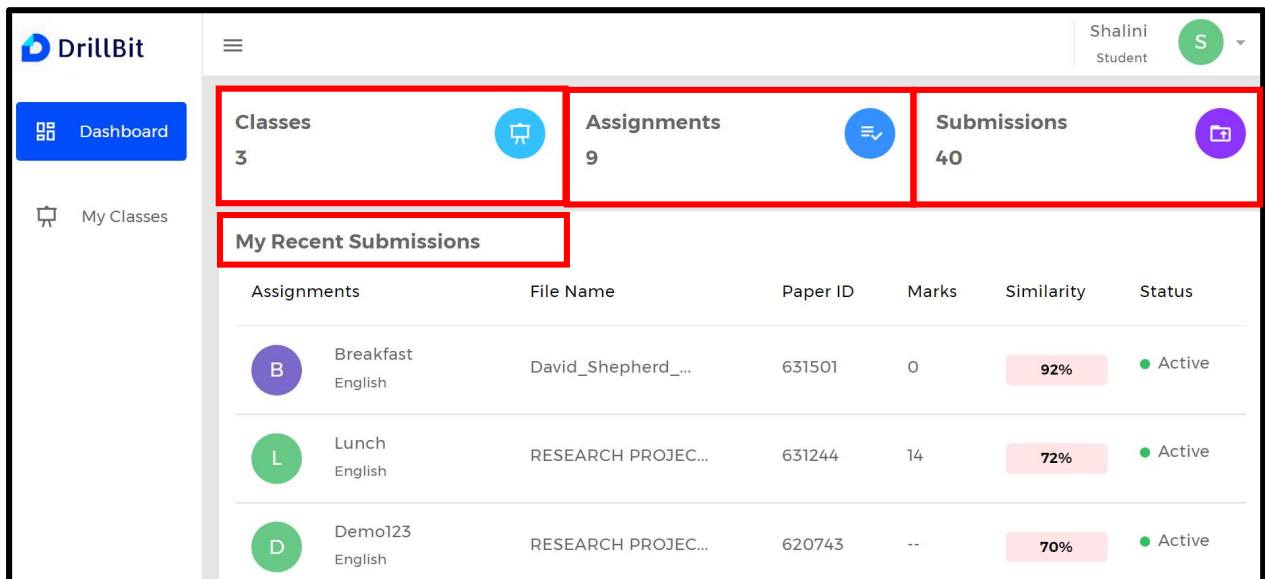

My Classes Tab

click on **My Classes** tab – to select the class & view assignments, click on **“Rightwards Arrow”**

1. Class Name
2. Instructor Name
3. validity of the class

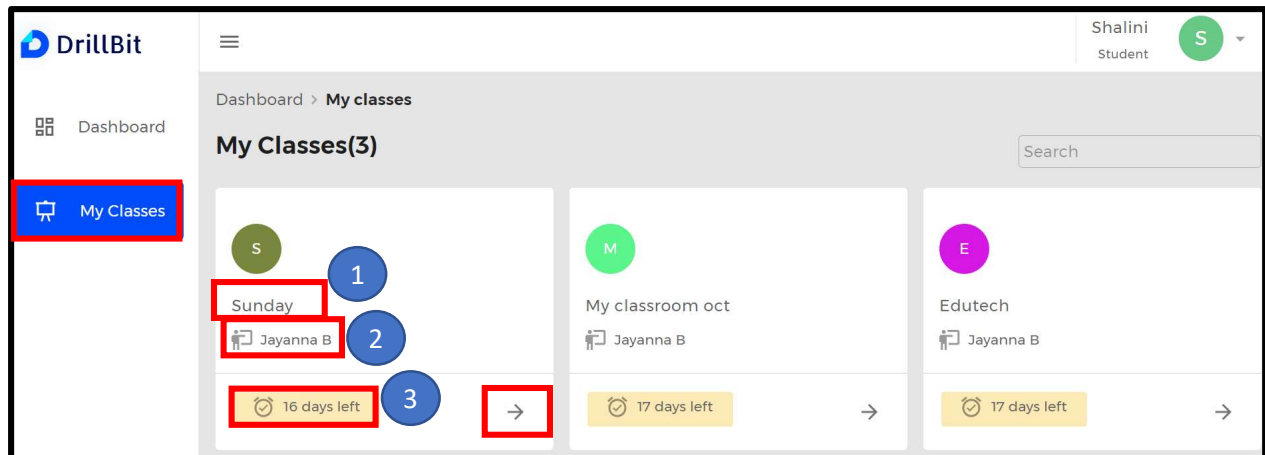

My Assignments page

click on **“SUBMIT”** icon – to select an assignment and submit the document

1. Assignment Name
2. Assignment instructions
3. validity of the assignment

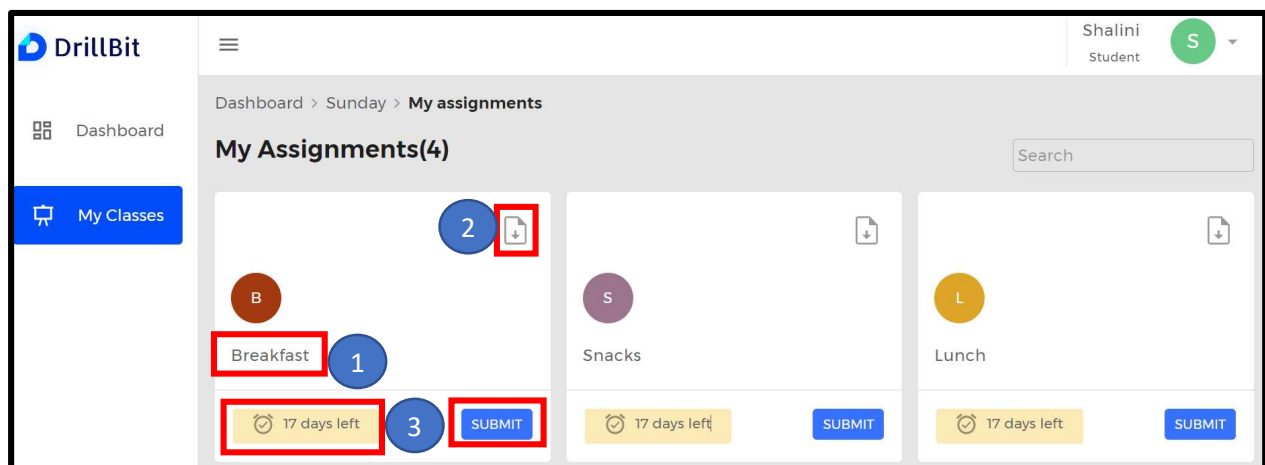

Submission page

Click on "+ add" icon to submit the assignment.

Dashboard > Sunday > breakfast > Submission details

Shalini Student (S) Active

Class name	Assignment name	Instructor name	Date
Sunday	Breakfast	Jayanna B	13/10/2022-31/10/2022

SUBMISSION Q&A

Filename ↑	Paper ID ↑	Date ↑	Grammar ↑	Similarity ↑	Marks ↑	Status	Feedback
David_Shep...	631501	2022-10-14...	NA	92%	0	Inactive	!
Sample (1)...	631500	2022-10-14...	NA	100%	0	Inactive	!
RESEARCH P...	631406	2022-10-13...	NA	...	10	Inactive	!

Upload page

Student name – auto filled

Assignment title – auto filled

Select the language – English or Non-English

Select the language in case of non-English assignment

browse the file and click on the submit to upload the file

View Student Submission

- 1. File name:** original file uploaded by the student, can be downloaded anytime
- 2. Paper ID:** unique id of each submission for tracking
- 3. Date:** submission date & time
- 4. Grammar:** if applicable, can view & download the grammar report
- 5. Similarity %:** assignment plagiarism %
- 6. Marks:** if applicable, instructor can assign marks for the assignment
- 7. Status:** the submitted assignment is active/inactive, it will be inactive in case of deleted by an instructor or resubmission by student
- 8. Feedback:** student can view the instructor text feedback given for the assignment
- 9. Refresh icon:** click on refresh to update the plagiarism % or reload the page.

SUBMISSION Q&A 9

Filename ↑	Paper ID ↑	Date ↑	Grammar ↑	Similarity ↑	Marks ↑	Status	Feedback
David_Shep...	631501	2022-10-14...	NA	92%	0	Inactive	!

Feedback from the Instructor.

Student can see obtained marks and text feedback.

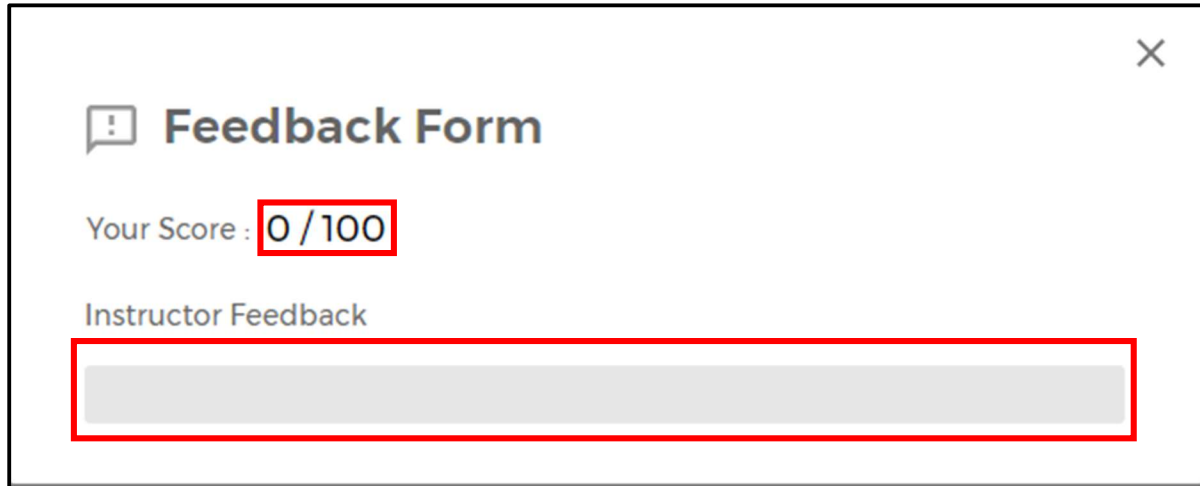

Question & Answer

click on the Q&A Tab, Student can view any questions added by an instructor in the assignment



student can answer the questions and click on "submit answer" icon

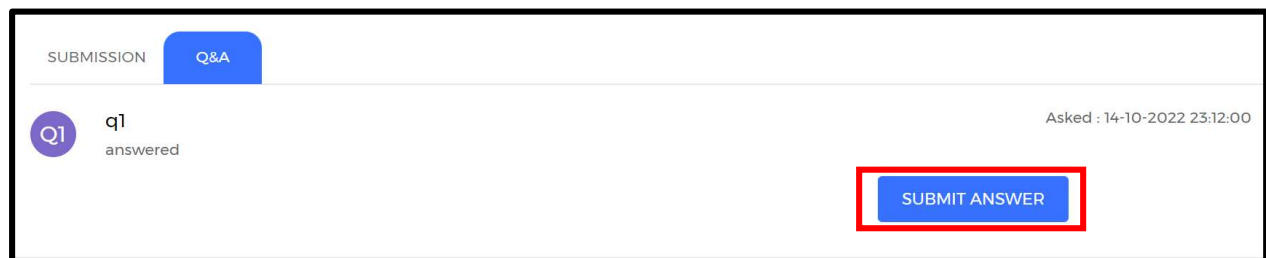

Student Profile

Click on student profile and select

1. Account info
2. Help
3. Change password

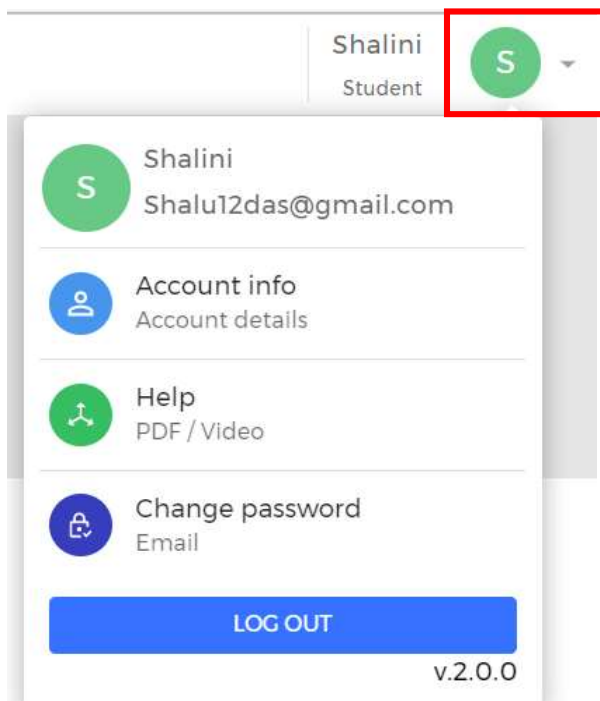

Account information: complete details of the student account

Account Information	
Account ID	27740
Student ID	234
Name	Shalini
Email	Shalu12das@gmail.com
Institution Name	DRILLBIT DEMO XTREAM
Department	Fff
Created Date	2022-10-09 12:46:50
Expiry Date	2022-12-31 00:00:00

Help

Student can download the PDF guides and video tutorials



Change password

Student can change the password by using “change password” option on the profile menu.

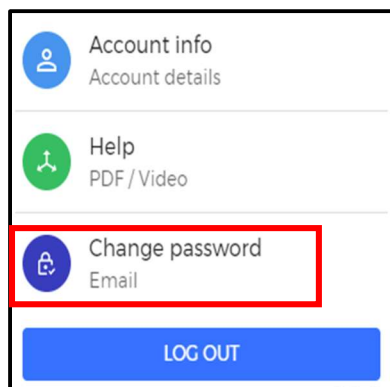

Enter the old password, enter the new password & confirm the new password, and click “change password” icon

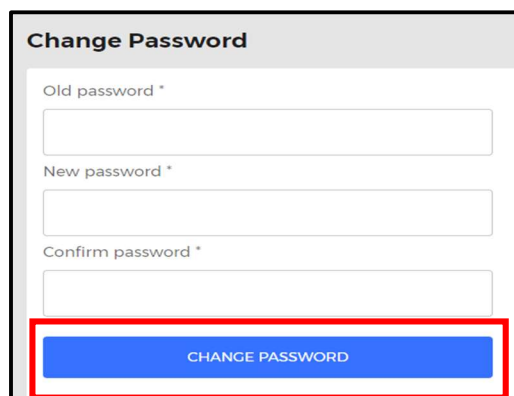
A screenshot of a 'Change Password' form. The title 'Change Password' is at the top left. Below the title are three input fields: 'Old password *', 'New password *', and 'Confirm password *'. At the bottom of the form is a blue button labeled 'CHANGE PASSWORD', which is highlighted with a red rectangular border.